

USE AND MAINTENANCE INSTRUCTIONS

1. Before using or reusing inspect product carefully. Discard any products that have cut, damaged, or frayed wire insulation or cords, cracks in the lampholders or enclosures, loose connections or exposed copper wire.
2. If you find a section that does not light, starting with the first unlit bulb, gently push (don't twist) each bulb firmly into the socket. At the same time, look and feel for a broken bulb in the socket or an empty socket where a bulb has fallen out. If a light flickers, you may have found a faulty bulb. Replace with a new bulb. (Remember to unplug the light set before replacing any bulbs)
3. If a bulb is broken, mark it with a piece of tape and unplug the tree before removing the bulb and any fragments. Replace the broken bulb.
4. If a bulb burns out, the remaining lights will stay lit. However, it is best to replace any burned out bulbs as soon as possible to prevent overheating.
5. When not in use, store neatly in a cool, dry location protected from sunlight.

FUSE REPLACEMENT INSTRUCTIONS

1. Unplug light set and remove from receptacle or other outlet device. Do not unplug by pulling on cord.
2. Open fuse cover by sliding open fuse access cover on top of attachment plug towards blades.
3. Remove fuse carefully, Turn fuseholder over and remove fuse.
4. Risk of fire: Replace fuse only with 5 Amp-125 volt fuse for the power cord set and 2 Amp-125 volt fuse for decorative lighting string (provided with product.)
5. Close fuse cover by sliding the fuse access cover on top of attachment plug.
6. Risk of fire: Do not replace attachment plug. It contains a safety device (fuse) that should not be removed. Discard product if attachment plug is damaged.

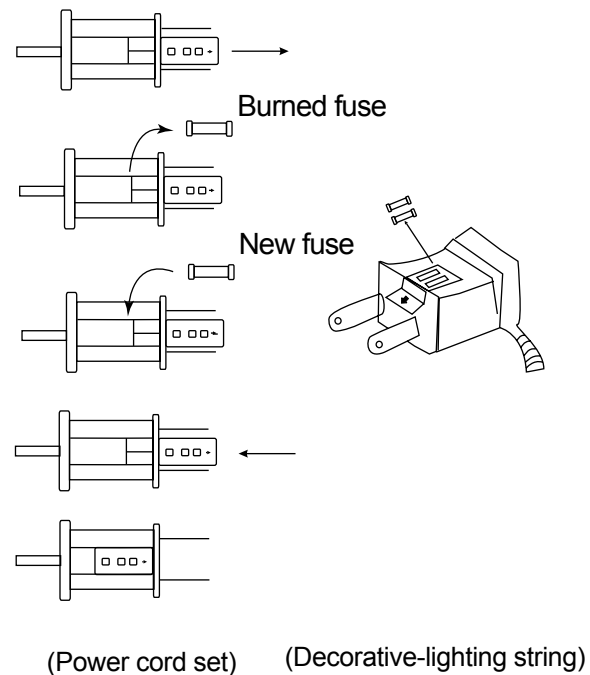

BULB REPLACEMENT INSTRUCTIONS

1. Unplug light set and remove from receptacle or other outlet device. Do not unplug by pulling on cord.
2. Lift up to unsnap locking tab (if present). Then pull bulb and plastic holder straight out of socket.
3. Replace bulb with only 2.5 volt push-in type bulb provided with product. (To reduce overheating, replace burned out bulbs promptly.)

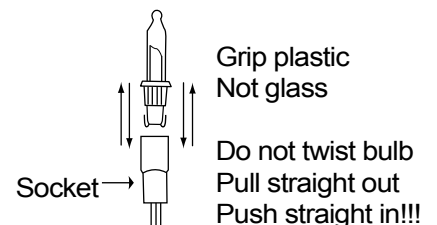

REPLACING BULB HOLDER INSTRUCTIONS

1. Bend the wires downward to release the bulb from the holder.
2. Insert the bulb into the holder.
3. Bend the wires upward.

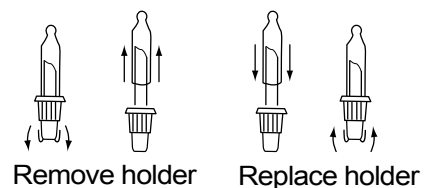

SPARE PARTS INCLUDED SAVE THESE INSTRUCTIONS

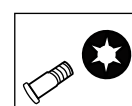

STAPLES

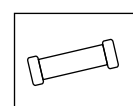

FUSE

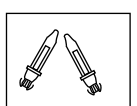

BULBS